



DisCone™ Chipper Advantage



DC50

DC55

Cutting Edge Chipping Technology

- Innovative "Cone" drum—unique slicing action reduces fuel consumption
- Forward-thinking design—disk style inertia and unmatched cone drum efficiency
- Superior chip quality and consistency—reach new chip buyers
- Industry best 5-year DisCone drum warranty with 1-year full machine warranty

Get the Dynamic DisCone™ Advantage

Field tests prove Dynamic cone chippers are 30-40% more efficient and effective than conventional drum chippers—our customers agree! Dynamic produces more chip tons per fuel gallon than traditional drum or disk designs.

Dynamic Manufacturing Corp
Weidman, MI 48893-0039
989-644-8109

www.DynamicMfgCorp.com



DC50

DC55

Dynamic DisCone™ Chipper Design

Revolutionary Chipping Performance - Different at the Core!

The patented DisCone design advantage delivers unmatched efficiency and consistent chipping performance.

Feeding is much faster and safer! The slicing DisCone action naturally pulls trees, branches and vines toward the smaller diameter of the cone. This design advantage lowers power requirements without reducing chip output.

The DisCone's superior slicing angle cuts uniform chips using less energy and lowering fuel costs per truckload! The cone drum slicing action keeps the blades sharp longer, reducing downtime for maintenance.

Dynamic's DisCone combines the flywheel inertia and material throw of a disk style chipper with the efficiency, reduced vibration and low noise of Dynamic's Cone Drum. The flywheel effect provides smoother, faster feeding while the large paddles move massive amounts of air to efficiently propel chips through the swivel discharge.

Dynamic chippers also feature; heavy-duty industrial strength construction, replaceable wear plates and wide throat opening for handling limbs and crotches with minimal trimming.

The Dynamic DisCone DC50 and DC55 are backed by an industry best 5-year drum warranty and a 1-year machine warranty.

Contact your local Dynamic dealer for more information.

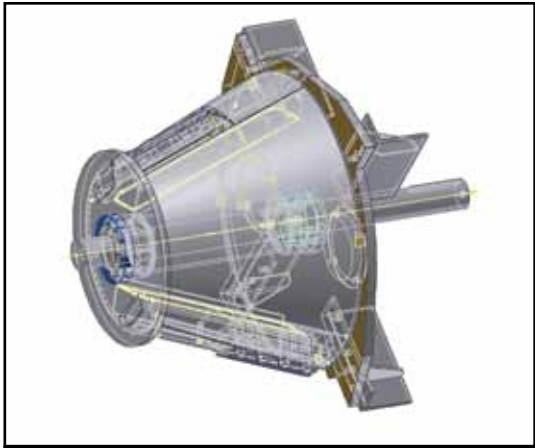

DisCone drum is more efficient, saves fuel.

Standard Equipment

Model	DC50	DC55		DC50	DC55
Drum Width	20" wide	20" wide	Feed Roller Drive	Planetary	Planetary
Disc Size	40" dia x 1" thick	40" dia x 1" thick	Horizontal Rollers	(1) 16" long, 15" dia	(2) 20" long, 15" dia
Feed Rate	100 ft/m	100 ft/m	Auto Feed Control	Yes - Standard	Yes - Standard
Infeed Apron	70" wide x 38" high	74" wide x 40" high	Roller Drive Shaft	2"	2"
Engine / HP	86 to 125 hp diesel	125 to 142 hp diesel	Feed Roller Blades	Carbon steel	Carbon steel
Throat Opening	16" wide x 12" high	25" wide x 15" high	Hydraulic Oil Tank	15 gal (57 liter) capacity	
Max Stem Size	12"	15"	Hydraulic Hoses	Industrial, 2500 psi, JIC 37° flar	
Ttl Lgth-Width	16' 5" L x 7' 0" W	17' 0" L x 7' 0" W	Hydraulic Filtration	10 Micron, spin-on in return line	
Total Weight	5,000 lb	7,000 lb	Chassis Structure	4" channel	6" channel
Chipper Drum	14" to 28" dia, knives in pockets		Axle capacity	6,000 lb	7,000 lb
Chipper Belly Pan	1/4" plate, shaped to drum		Brakes	12v, self adjusting	
Integral Disk	40" dia, 4 paddles 5.5" x 11" - 1" thick		Breakaway Switch	12v, steel guarded	
Knives	A8 steel, 10" L x 5" W x 1/2" thick (2) separate knives	(4) separate knives	Tires	(2): LT245/75R16 on 8" x 16" rims	
Chipper Shaft	ASTM A311, 3" stepped to 2 15/16" fatigue proof, solid, machined		Tow Bar Length	43"	65"
Bearing Rating	10,000 hr svc life 35,000 lb dynamic, 4,400 lb radial		Tow Bar	4" x 4" x 3/8" Tube, 2 1/2" ID Pintle	
Chipper Drive	Belt, 5v sheaves, (1) 4-banded belt		Fuel Tank	25 gal (95 liter)	
Feed Plate Anvil	Adjustable fit, 2 usable edges		Lighting	12v, sealed taillights, shock mount	
Feed Apron	70" W x 38" H	74" W x 40" H	Jack Stand	7,000 lb capacity	
Discharge	Rotates 360°, lockable every 5°				
Controls	Curbside for operator safety				

* Specifications are subject to change without notification Illustrations may not reflect actual product design. Consult dealer for available options.